

Minna Street

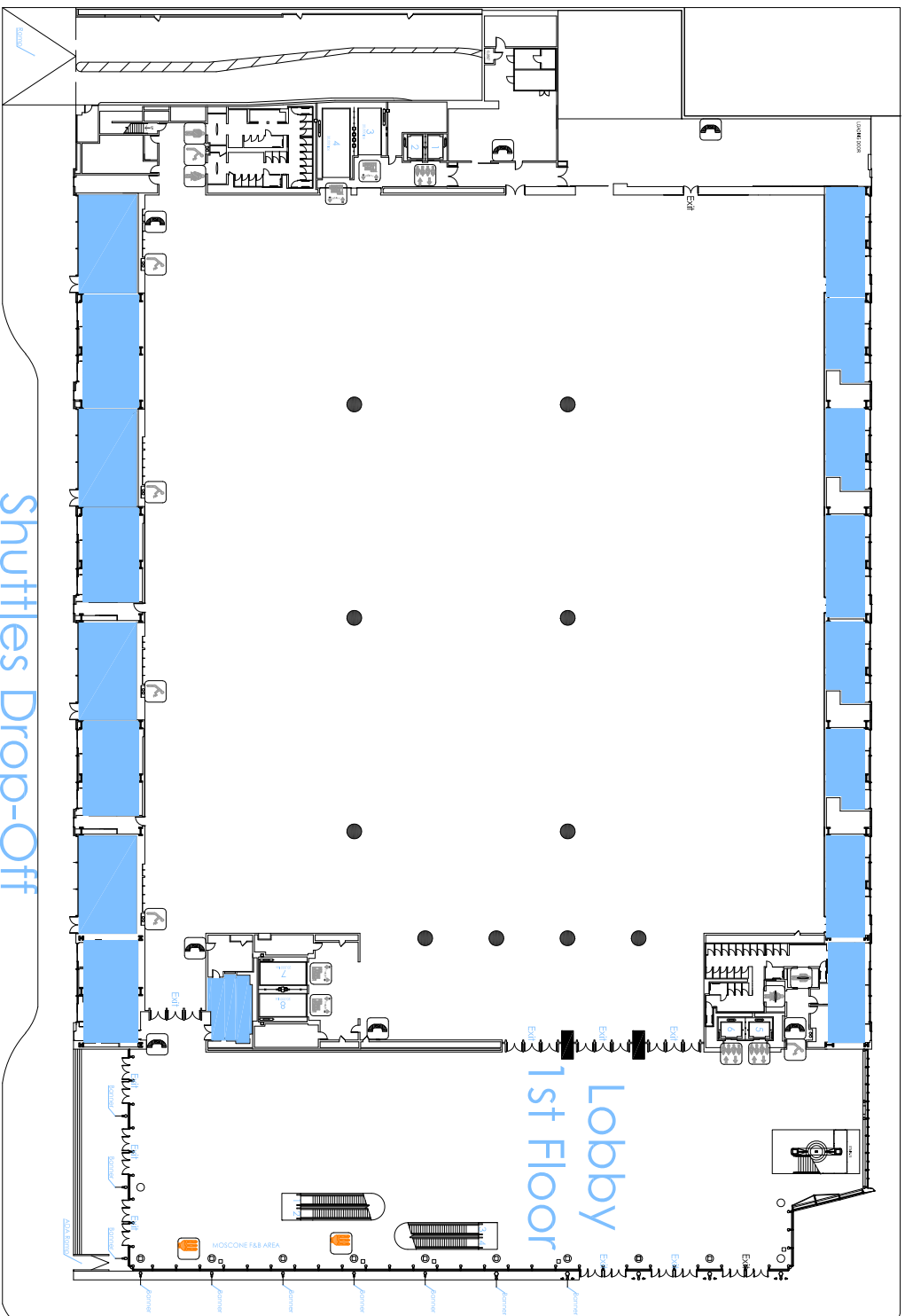

4th st.

Shuttles Drop-Off  
Howard Street

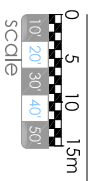

**sign-wayfinding**

	Sign		Wayfinding
	Sign		Wayfinding
	Sign		Wayfinding
	Sign		Wayfinding
	Sign		Wayfinding
	Sign		Wayfinding

# West Level One

**Disclaimer:**  
 This drawing is intended as a guide only.  
 The Moscone Center/SMG cannot be held  
 responsible for on-site verifications or  
 adjustments.

Mirna Street

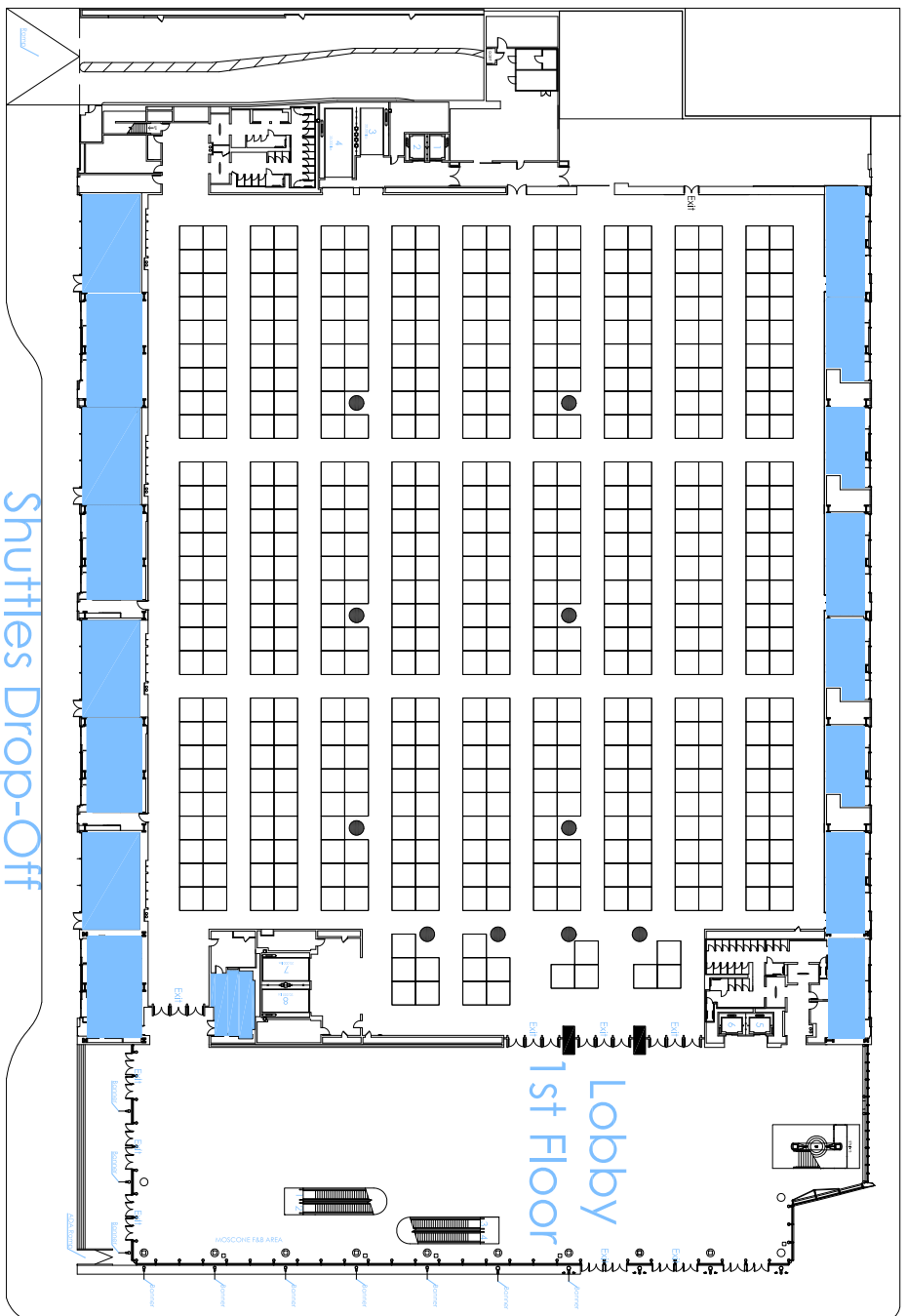

Shuttles Drop-Off  
Howard Street

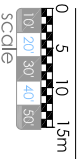

Booth Inventory as of 02/21/2021  
MC West Level 1 Booths

Level 1 - 496 Booths  
0% - 0 SqFt Rented  
100% - 49,600 SqFt Available

Dimension	Size	Qty	SqFt	Rented	Available
10'x10'	100	496	49,600	0	496
Totals:	496	49,600	0	496	

West Level One

booth

**Disclaimer:**  
This drawing is intended as a guide only.  
The Moscone Center/SMG cannot be held  
responsible for on-site verifications or  
adjustments.

04/30/2024



West Level One  
Utilities

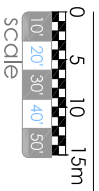

**Legend**

- Double Floor Outlet
- Double Outlet 20 Amp
- 30 Amp Neutral + Outlet + Meter
- HVAC System 1
- HVAC System 2
- Fluor Fuel
- 250 Amp
- 400 VARS

**utilities**

Shuttles Drop-Off  
Howard Street

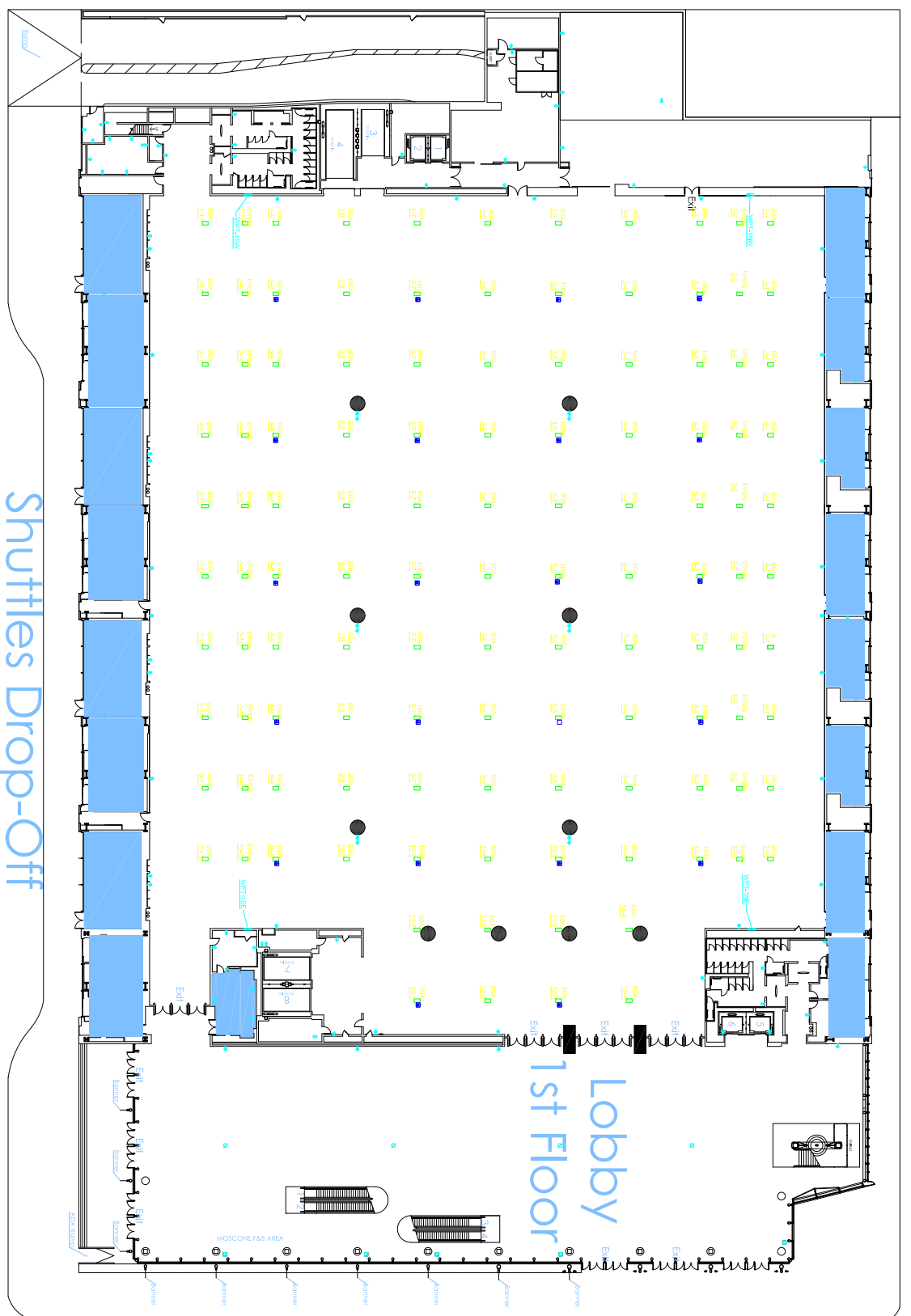

Lobby  
1st Floor  
4th St.

**Disclaimer:**  
This drawing is intended as a guide only. The Moscone Center/SMG cannot be held responsible for on-site verifications or adjustments.  
04.30.2024



# West Level One Rigging

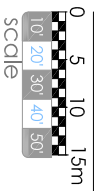

NOTES:  
- RIGGING EXERCISE POINTS ARE INTD AT 2000LBS IN  
ANY DIRECTION  
- HIGHEST POINT TO CEILING 27'  
- HIGHEST FROM FLOOR TO BOTTOM OF EXERCISE 4.200"

● - RIGGING EXERCISE POINT  
○ - RIGGING POINT UNDER REPAIR

rig points

## Shuttles Drop-Off Howard Street

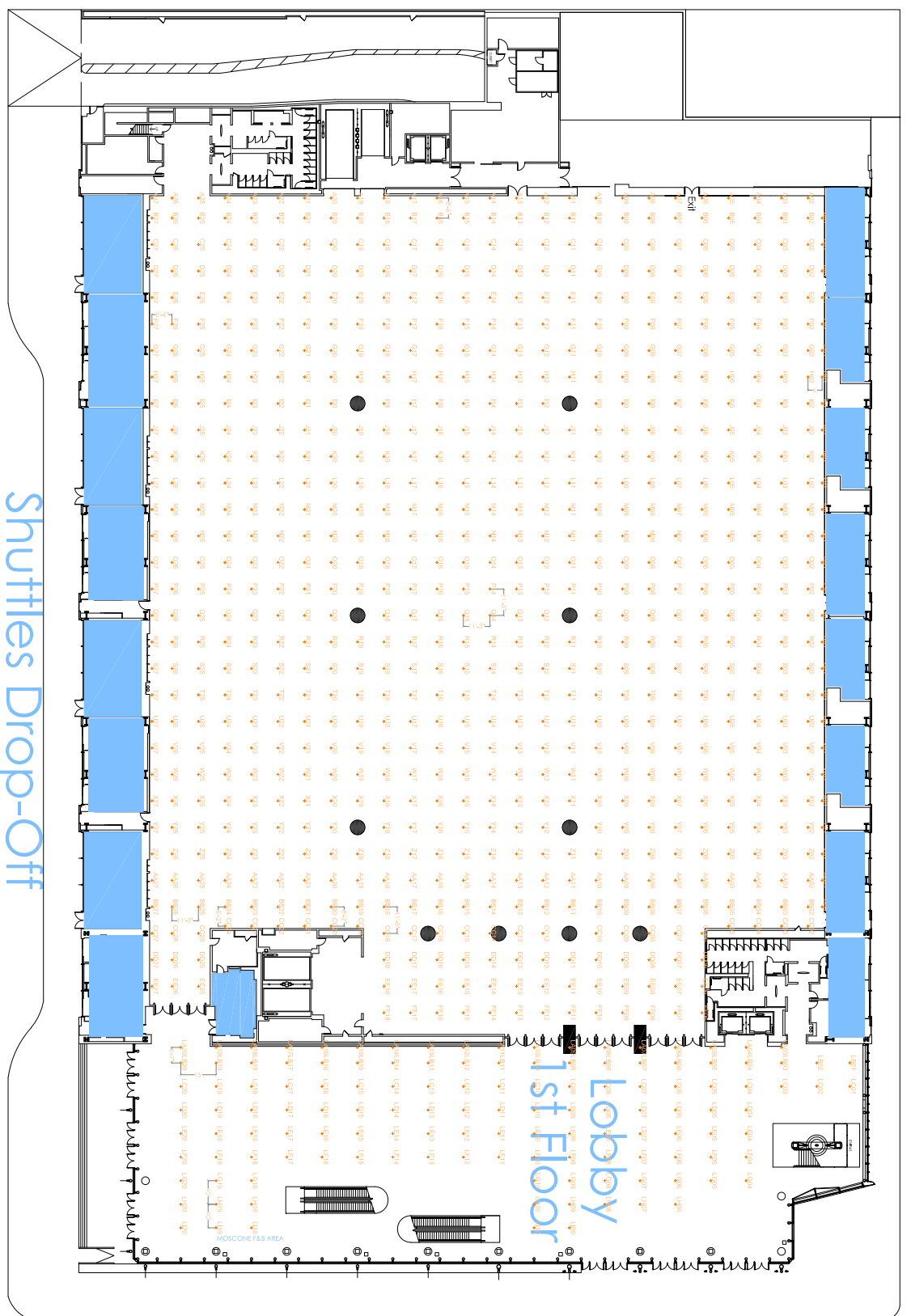

**Disclaimer:**  
This drawing is intended as a guide only.  
The Moscone Center/SMG cannot be held  
responsible for on-site verifications or  
adjustments.



West Level One  
Keep Clear

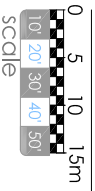

**sign-wayfinding**

- Exit
- Stair
- Elevator
- Restroom
- Men
- Women
- Smoking
- First Aid
- Security
- Information
- Phone
- ATM
- Wheelchair Accessible
- Service Animals
- Signage
- Wayfinding

Shuttles Drop-Off  
Howard Street

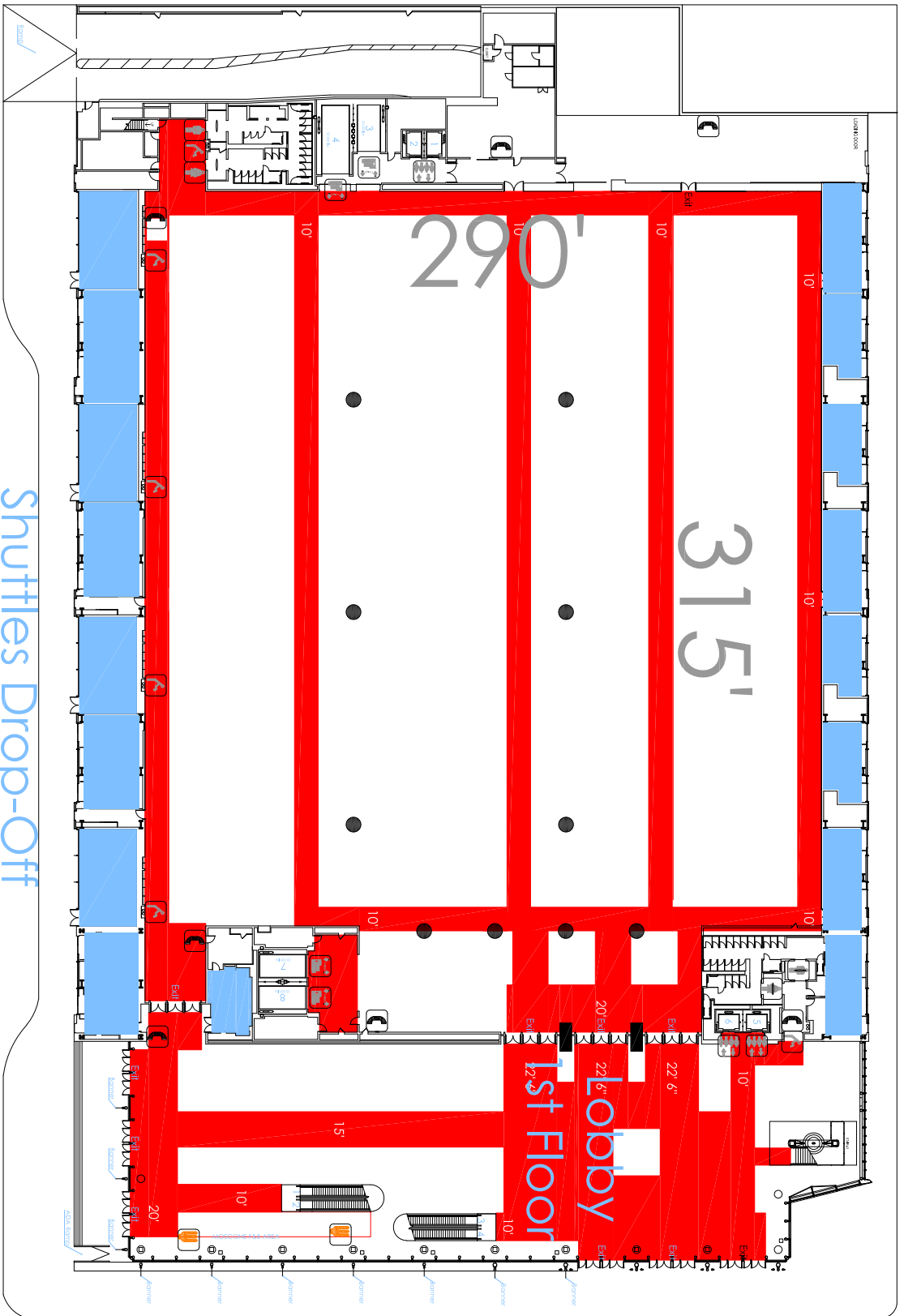

4th st.

**Disclaimer:**  
This drawing is intended as a guide only.  
The Moscone Center/SMG cannot be held  
responsible for on-site verifications or  
adjustments.